

SOUND BARRIER SYSTEMS MADE OF CONCRETE

Sound barriers made of concrete fulfill all quality, usefulness and visual requirements. The elements can be manufactured as reflecting or highly absorbent structures. In order to achieve the highly absorbent effect, a light concrete shell in a corrugated or ribbed structure is poured onto a concrete bearing plate. A wide range of different surface structures can be supplied for the reverse side of the elements, such as brush marks or matrix structures. A colored design is possible either by dyeing the concrete in the factory or by using a special injection method on site, depending on the client's requirements.

● Sound Barrier System Concrete Reflecting, Absorbing and Highly Absorbent

Technical Data / Dimensions / Material

- Reflecting design versions
- Versions absorbent on one or both sides (highly absorbent) are possible
- Possible to color the concrete by dyeing
- Possible to color the concrete by injection using various systems
- Panel sizes up to 20 ft in length

- Reflecting version (≥ 4 dB)
Plane or structured concrete surfaces
Both sides can be designed (smoothed, brush or rake structure, matrix panelling etc. possible)

- Absorbing version (≥ 8 dB)
Plane or structured foam mortar (one or both sides)

- Highly absorbent version (≥ 8 dB)
Highly absorbent side (foam mortar) with wave, trapezoidal or cassette structure
Reverse (resident side): different design possibilities
Absorption surface can also be given a design on both sides

- The concrete elements can also be used as paneling for supporting walls, bridges etc.



BECK

SoundBarrierSystems

Systems made of
CONCRETE

highway view

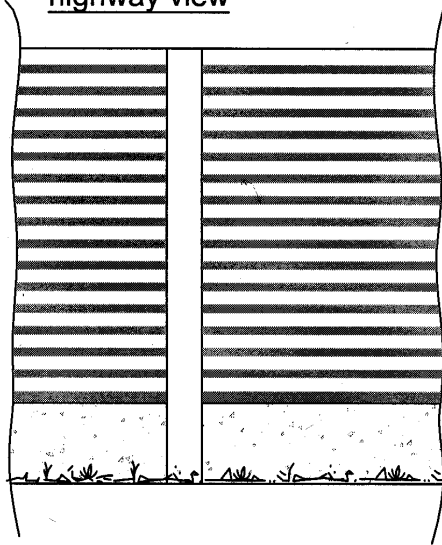

vertical cross section

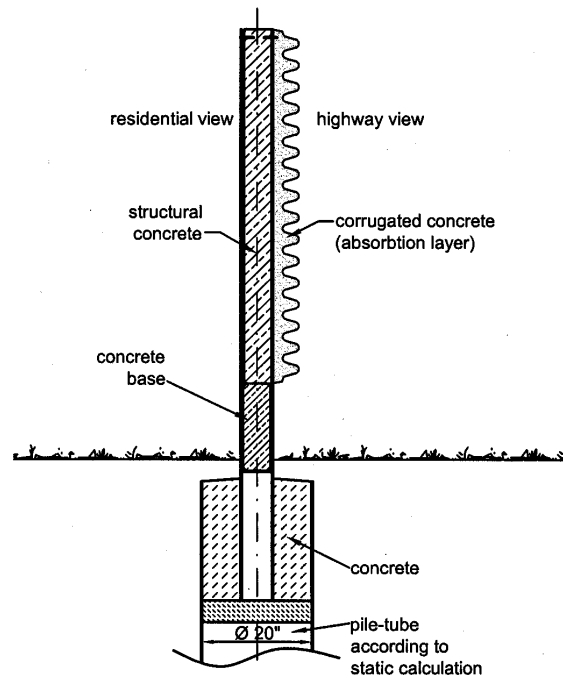

section A-A

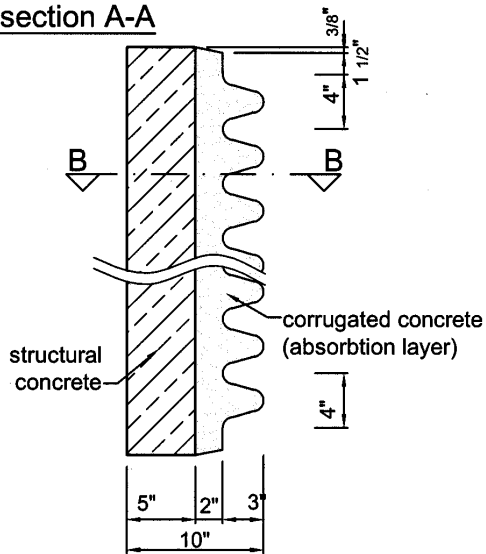

section B-B

